

# TRG 450W

# WATER-COOLED MIG GUN

Replacement Suitable for Tregaskiss®

RATING	GUN ORDERING PART NUMBER	GUN PLUG Direct Connect
<b>450 Amp CO2 @ 80% Duty Cycle</b>  <b>325 Amp Mixed Gas @ 80% Duty Cycle</b>  <b>Wire Capacity: 0.030" (0.8mm) - 5/64" (2.0mm)</b>	R45xx-45	Tweco® #4
	RLN45xx-45	Lincoln® "LN"
	RLF45xx-45	Linc® LF/Powerfeed 10
	RM45xx-45	Miller®
xx = Standard lengths of 10, 12, 15, 20 and 25 ft. Custom lengths also available.		

#	Part Number	Description	
1.	R403-1-30	Contact Tip, H.D., .030" 0.8mm	
	R403-1-35	Contact Tip, H.D., .035" 0.9mm	
	R403-1-1.0	Contact Tip, H.D., .040" 1.0mm	
	R403-1-45	Contact Tip, H.D., .045" 1.2mm, Std.	
	R403-1-364	Contact Tip, H.D., 3/64" 1.3mm	
	R403-1-52	Contact Tip, H.D., .052" 1.4mm	
	R403-1-116	Contact Tip, H.D., 1/16" 1.6mm	
	R403-1-564	Contact Tip, H.D., 5/64" 2.0mm	
2.	R403-1-332	Contact Tip, H.D., 3/32" 2.4mm	
	R403-3-30	Contact Tip, H.D., Tapered, .030" 0.8mm	
	R403-3-35	Contact Tip, H.D., Tapered, .035" 0.9mm	
	R403-3-1.0	Contact Tip, H.D., Tapered, .040" 1.0mm	
	R403-3-45	Contact Tip, H.D., Tapered, .045" 1.2mm	
	R403-3-52	Contact Tip, H.D., Tapered, .052" 1.4mm	
	R403-3-116	Contact Tip, H.D., Tapered, 1/16" 1.6mm	
	3.	R451-1-62	Nozzle, H.D., 5/8", 1/4" Tip Recess
R451-1-75		Nozzle, H.D., 3/4", 1/4" Tip Recess	
R451-5-62		Nozzle, 5/8", 1/4" Tip Recess	
R451-5-75		Nozzle, 3/4", 1/4" Tip Recess	
R451-6-50		Nozzle, 1/2", 1/8" Tip Recess	
R451-6-62		Nozzle, 5/8", 1/8" Tip Recess, Std.	
R451-6-75		Nozzle, 3/4", 1/8" Tip Recess	
R451-8-62		Nozzle, 5/8", 1/4" Tip Stickout	
R451-61-62		Nozzle, H.D., 5/8", 1/8" Tip Recess	
R451-81-62		Nozzle, H.D., 5/8", 1/4" Tip Stickout	
4.		R454-1	Retaining Head
4a.		R454-1-2	Replacement Retaining Ring
4b.	R402-6	Replacement O-Ring	
5.	R455-45	Gooseneck, 45°	
	R455-60	Gooseneck, 60°	
	R455-180	Gooseneck, 180°	

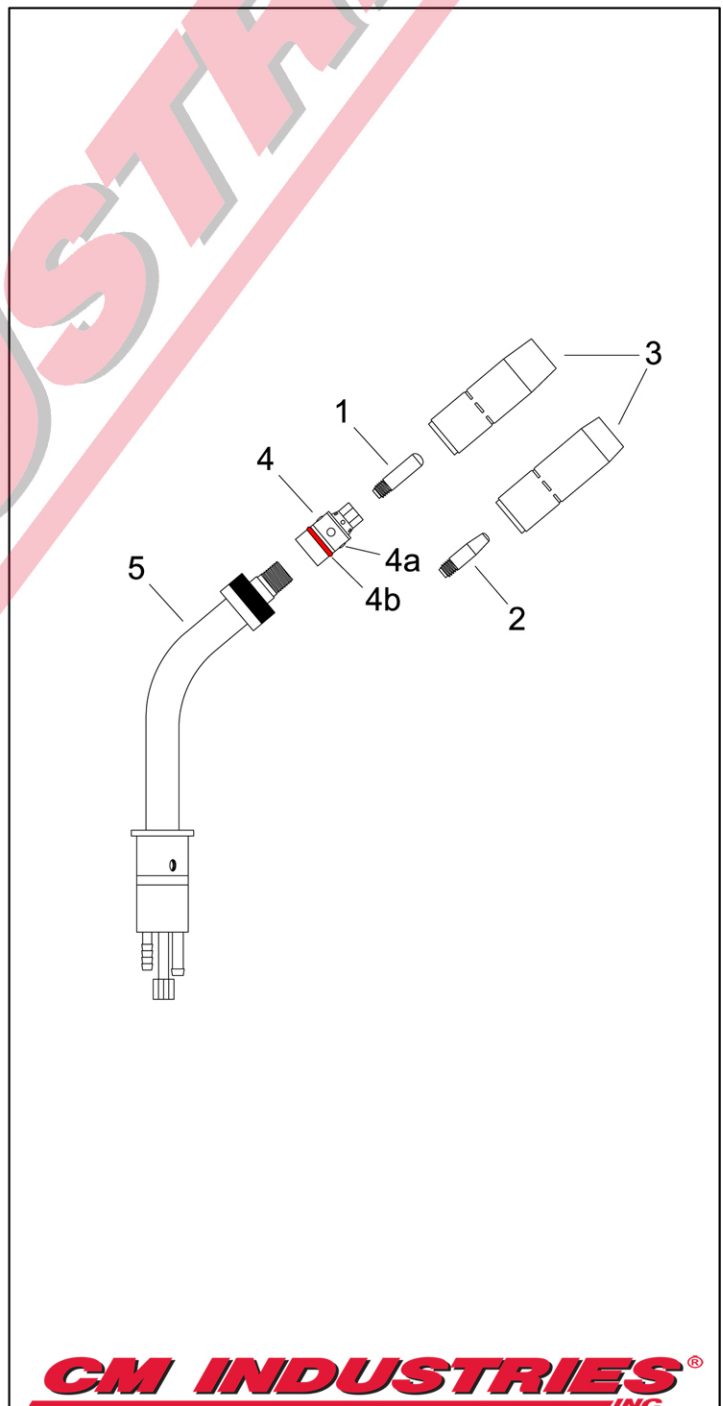

**CM INDUSTRIES**  
INC.

#	Part Number	Description
6.	R411-1	Switch Only
7.	R412-1	Switch Terminals
8.	R411-2	Switch Housing
9.	R411-3	Mounting Screw
10.	R610	Handle w/ Spring
11.	R663-1-10	Cable Cover, 10'
	R663-1-12	Cable Cover, 12'
	R663-1-15	Cable Cover, 15'
	R663-1-20	Cable Cover, 20'
	R663-1-25	Cable Cover, 25'
12.	R659-10	Power Cable, 10'
	R659-12	Power Cable, 12'
	R659-15	Power Cable, 15'
	R659-20	Power Cable, 20'
	R659-25	Power Cable, 25'
13.	R656-10	Water Hose, 10'
	R656-12	Water Hose, 12'
	R656-15	Water Hose, 15'
	R656-20	Water Hose, 20'
	R656-25	Water Hose, 25'
14.	R656-1	Hose Clamp
15.	R657	Conduit (sold per ft.)
16.	R657-1	Conduit Clamp
17.	R416-5	Control Housing Only
18.	R664-1	Quick Connector Power Block Assembly
19.	R658-1	Blue Water Line IN, 2'
20.	R658	Red Water Line OUT, 2'
21.	350-52-001	Male Water Fitting
22.	R664-12	Power Pin, Tweco #4
23.	R664-12	Power Pin, Lincoln "LN"
24.	R664-11-116	Power Pin, Miller
25.	R414-11-2	O-Ring, Miller
26.	R414-116	Guide Cap, Miller .035"-1/16" Wire
	R414-332	Guide Cap, Miller 5/64"-3/32" Wire
27.	300-05-002	Electrical Plug, Lincoln
28.	300-05-001	Electrical Plug, Miller
29.	R415-30-15	Liner Assembly .030", 15'
	R415-35-15	Liner Assembly .035"-.045", 15'
	R415-116-15	Liner Assembly .045"-1/16", 15'
	R415-564-15	Liner Assembly, 1/16"-5/64", 15'
	R415-332-15	Liner Assembly, 5/64"-3/32", 15'
	R415-35-2	Liner Assembly .035"-3/64", 15' Aluminum
	R415-116-2	Liner Assembly 3/64"-1/16", 15' Aluminum
	R415-35-0	Teflon Liner Assy., .035"-3/64", 15' Aluminum
	R415-116-0	Teflon Liner Assy., 3/64"-1/16", 15' Aluminum
	R415-35-25	Liner Assembly .035"-.045", 25'
	R415-116-25	Liner Assembly .045"-1/16", 25'
	R415-564-25	Liner Assembly, 1/16"-5/64", 25'
	R415-332-25	Liner Assembly, 5/64"-3/32", 25'

